

WINDHAM COUNTY

HALIFAX, VERMONT

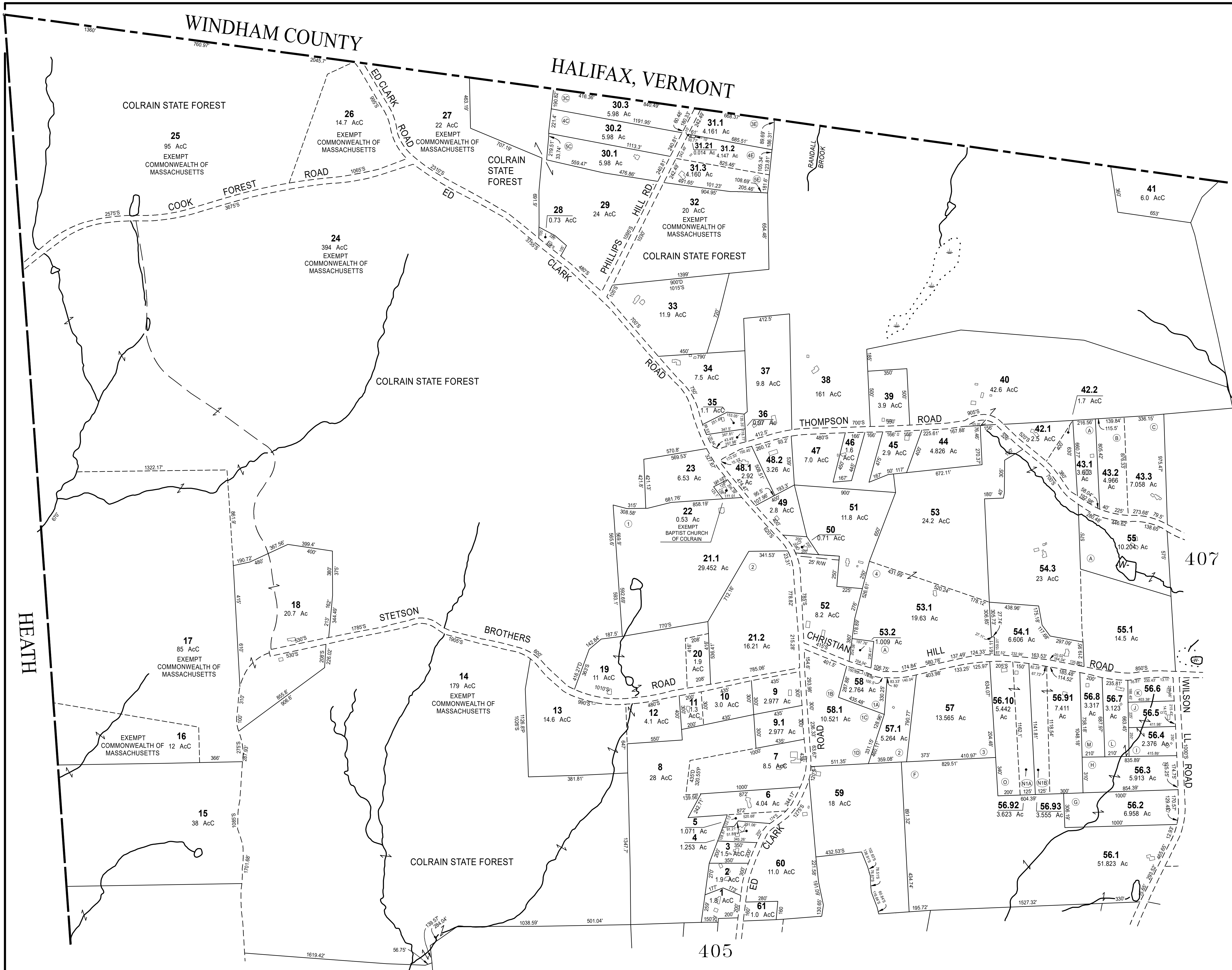

THIS MAP IS FOR ASSESSMENT PURPOSES. IT IS NOT VALID FOR LEGAL DESCRIPTION OR CONVEYANCE.

THE HORIZONTAL DATUM IS THE MASSACHUSETTS STATE PLANE COORDINATE SYSTEM, NAD 83.

ORIGINAL PROPERTY MAPS WERE PREPARED BY GORDON E. AINSWORTH & ASSOCIATES, INC. MAPS WERE REVISED AND REPRINTED BY CAI TECHNOLOGIES

DATE FLIGHT: MAY 3, 1981 DATE DELIVERY: MARCH 11, 1982

REVISED + REPRINTED BY

CAI Technologies
Precision Mapping. Geospatial Solutions

11 Pleasant Street, Littleton, NH 03561
800.322.4540 - www.cai-tech.com

LEGEND

AREA SURVEYED	-----	Ac	EXEMPT PROPERTY	-----	EXEMPT
AREA CALCULATED	-----	AcC	SUBDIVISION LOT NO.	-----	(2)
RECORD DIMENSION	-----	100'	RIGHT OF WAY/ACCESS	-----	60'
SCALED DIMENSION	-----	100'S	COMMON OWNERSHIP	-----	OR
MATCH LINE	-----	M.L.	ADJACENT SHEET NO.	-----	401

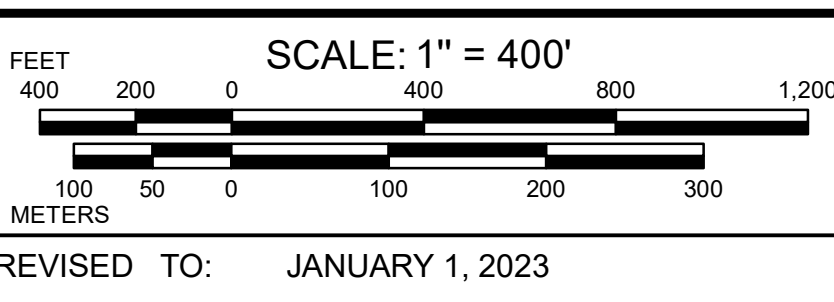

PROPERTY MAPS

COLRAIN

MASSACHUSETTS

MAP NO.

406