

408

417

404

118

118

113

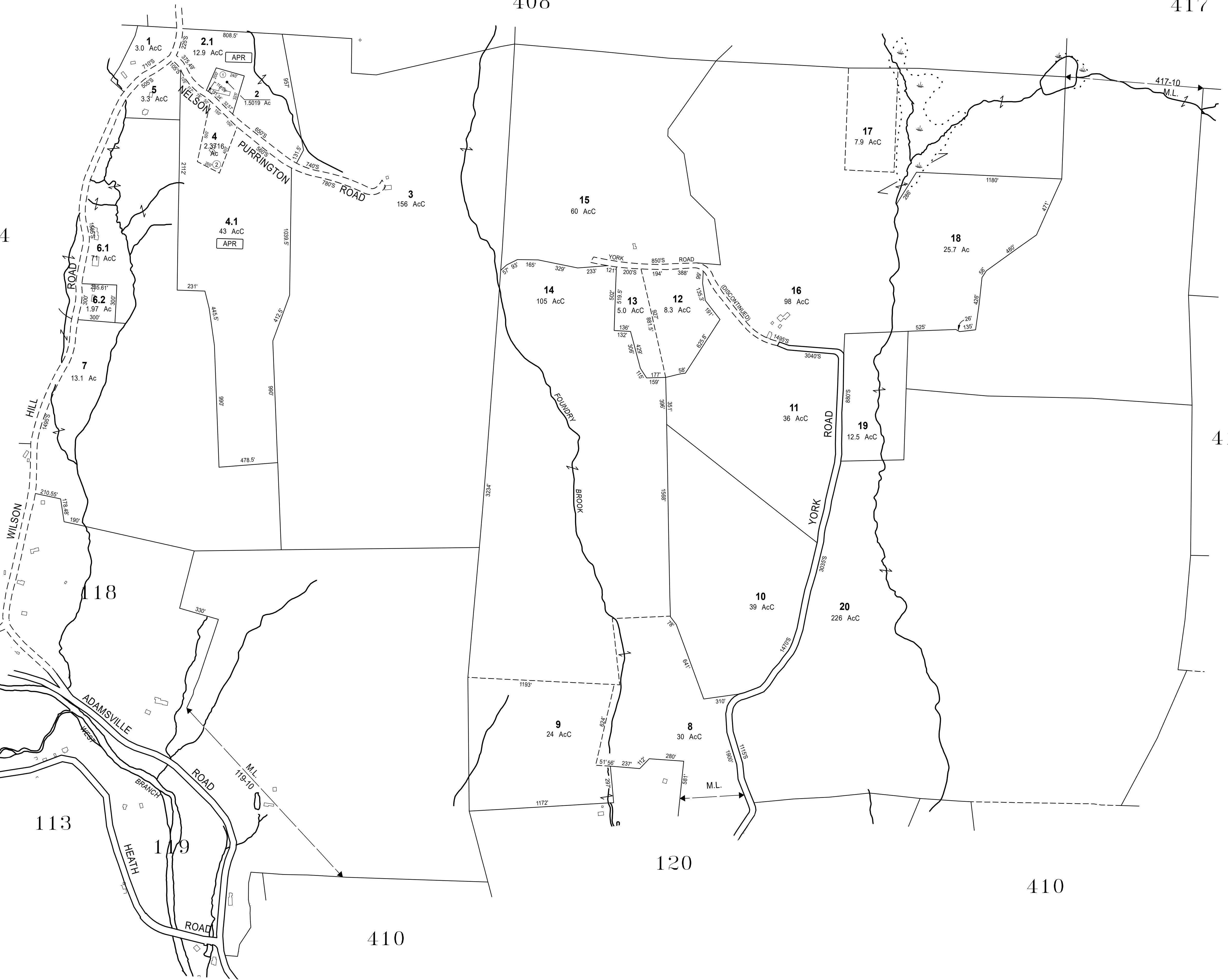

THIS MAP IS FOR ASSESSMENT PURPOSES. IT IS NOT VALID FOR LEGAL DESCRIPTION OR CONVEYANCE.
 THE HORIZONTAL DATUM IS THE MASSACHUSETTS STATE PLANE COORDINATE SYSTEM, NAD 83.
 ORIGINAL PROPERTY MAPS WERE PREPARED BY GORDON E. AINSWORTH & ASSOCIATES, INC. MAPS WERE REVISED AND REPRINTED BY CAI TECHNOLOGIES
 DATE FLIGHT: MAY 3, 1981 DATE DELIVERY: MARCH 11, 1982

REVISED + REPRINTED BY
CAI Technologies
 Precision Mapping. Geospatial Solutions.
 11 Pleasant Street, Littleton, NH 03561
 800.322.4540 - www.cai-tech.com

LEGEND

AREA SURVEYED	Ac	EXEMPT PROPERTY	EXEMPT
AREA CALCULATED	AcC	SUBDIVISION LOT NO. (2)	
RECORD DIMENSION	100'	RIGHT OF WAY/ACCESS	
SCALED DIMENSION	100'S	COMMON OWNERSHIP	
MATCH LINE	M.L.	ADJACENT SHEET NO.	401

SCALE: 1" = 400'

FEET: 400 200 0 400 800 1,200
 METERS: 100 50 0 100 200 300
 REVISED TO: JANUARY 1, 2020

PROPERTY MAPS
COLRAIN
 MASSACHUSETTS

MAP NO.
409